

# QT 250 EXD & QT800 EXD QUARTER-TURN ACTUATOR

## COMPACT QUALITY

QT250 EXD quarter-turn actuator is suitable for medium sized butterfly and ball valves with an operating torque of 50Nm - 250 Nm, QT800 EXD quarter-turn actuator is suitable for 160Nm - 800Nm, and suitable for use in a wide variety of industrial environments. Both can be used in EX environments

**ELTORQUE** offers a high level of precision in the control of valves. Excellent controlling possibilities, low cost of installation and operation, and no need of maintenance make ELTORQUE the solution of the future.

### FEATURES:

- Max torque: 250 Nm/800 Nm
- Valve range: DN50 - DN400
- Mechanical self-lock device locks valve position
- Absolute position feedback (true feedback)
- Removable cover for hand wheel protection
- Strong enclosure
- Configurable torque, closing time and position
- EXD certificate, Ex d e IIBT4 Gb
- Compact Ex protection design
- Maintenance free actuator
- Full valve control with positioning on IAS
- Low power consumption, high efficiency, green solution
- Manual emergency override as standard
- Quarter-turn (90°) travel, can easily be configured to an operation area within the range 0-359°
- Easy commissioning
- Flexible control interfaces for easy integration with a wide range of control systems

### FEATURES:

- CAN, Digital, Analog interface

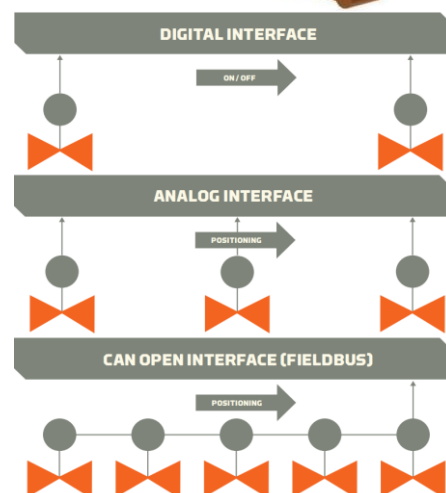

# QT250 EXD & QT800 EXD

## SPECIFICATIONS

	QT250 EXD				QT800 EXD		
MIN-MAX TORQUE <sup>1</sup>	50 – 250 Nm				160 – 800 Nm		
PART NUMBERS	Digital EXD250.115.15	Analog EXD250.135.10	CAN EXD250.125.1		Digital EXD800.115.15	Analog EXD800.135.10	CAN EXD800.125.1
MIN-MAX CLOSING TIME 0 – 100% / 0 – 90°	13 – 60 s				42 – 180 sec		
VALVE SPINDLE ADAPTER	5Q17				5Q27		
VALVE FLANGE	F05, F07, F10 (According to ISO5211)				F10, F12 (According to ISO5211)		
VALVE APPLICATIONS	Butterfly or ball valves with part-turn operation. Examples butterfly valves:						
	DN50 – DN200 PN16				DN250 – DN400 PN16		
PHYSICAL PROPERTIES							
WEIGHT <sup>3</sup>	15.2 kg				24.0 kg		
DIMENSIONS H/W/D <sup>3</sup>	275 mm/160 mm/263 mm						
HOUSING	IP68 (10m 72h) - Corrosion protected aluminum enclosure.						
COLOR	Black						
OPERATING CONDITIONS	-25°C to 70°C Not designed for use on open deck of ships, outdoor or exposure to corrosive chemicals.						
TEMPERATURE PROTECTION	Motor current is switched off in case of over-heating. Stator coils serve as heating elements in case of low temperatures.						
ELECTRICAL AND CONTROL PROPERTIES							
POWER SUPPLY	110 – 240 V AC ± 10%, 50/60Hz, Max 130W, Standby: <15W						
CABLE GLANDS	Up to four M20 glands allows serial connection of power supply and fieldbus wiring. Threaded holes in actuator capsule. Use IP68 glands for all cables, EMC type for fieldbus wiring.						
INTERFACE OPTIONS	<b>Digital (Open – Close), Analog (4-20mA), CANopen (Fieldbus):</b> CanOpen: Max 127 nodes per network, allows positioning and other extended control of actuator. Number of nodes will be limited by control system.						
POSITION SENSOR	Resolution 0.39%/ 0.35° & range 360° Absolute position sensor provides correct feedback even after a power failure.						
CONFIGURATION	USB connection to PC with E3C or Eltorque Manager 3.						
CONFIGURABLE PARAMETERS	Open and Closed positions. Actuator speed, torque and valve position regions. Inverted IO or fieldbus parameters depending on control interface.						
EMERGENCY AND SAFETY							
MANUAL OPERATION	Standard feature using fixed hand-wheel. Mechanical valve position indicator.						
COVER OF HAND WHEEL	Can be removed and refitted without tools. Protects mechanism against mechanical damage and foreign objects.						
NUMBER OF TURNS	21 for 0-100% / 0-90° valve operation				73 for 0-100% / 0-90° valve operation		
CERTIFICATIONS/TYPE APPROVAL <sup>2</sup>	CE-marked, CCC Certificate, DNV ATEX, IECEx						

<sup>1</sup> Configurable using Eltorque E3C or Manager 3 PC software.

<sup>2</sup> Adapted flange bracket and spindle connection is required and must be ordered with the actuator.

<sup>3</sup> Weight and Dimensions do not include valve adapter

**QT250 EXD**

**QT800 EXD**

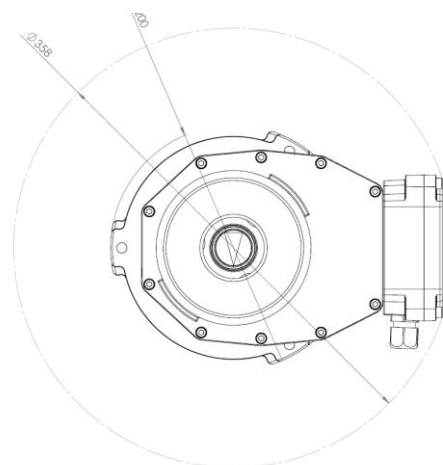
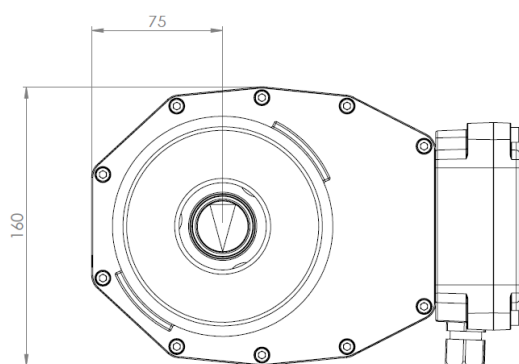
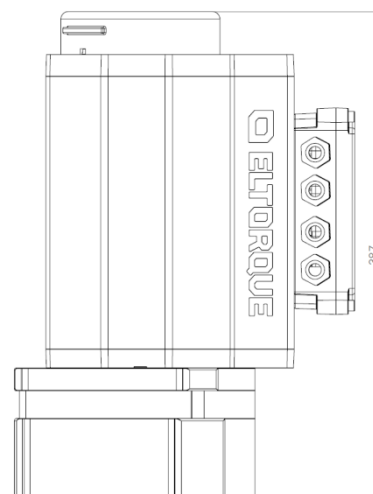
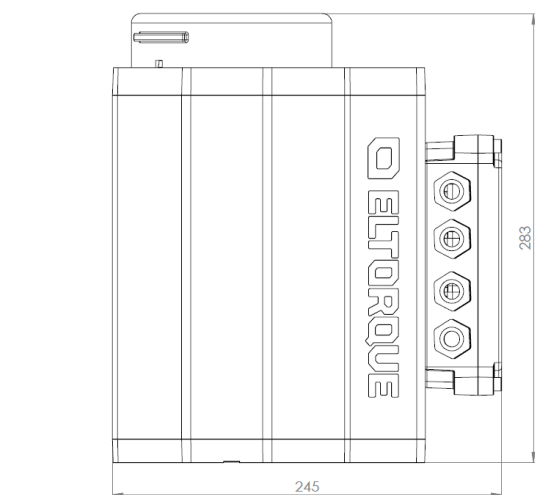

4x  $\phi 8,50 \nabla 28$   
M10 - 6H  $\nabla 25$   
4x  $\phi 6,80 \nabla 26,25$   
M8 - 6H  $\nabla 20$   
4x  $\phi 5 \nabla 20$   
M6 - 6H  $\nabla 15$

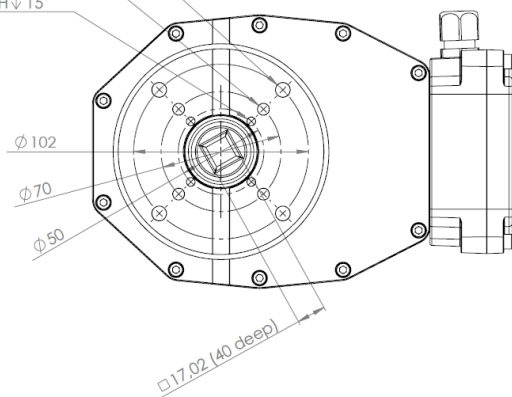

4x  $\phi 10,20 \nabla 38,75$   
M12x1.75 - 6H  $\nabla 30$   
4x  $\phi 8,50 \nabla 32,50$   
M10x1.5 - 6H  $\nabla 25$

